

# WL2PA

Outboard & Apex Aluminum  
Split Flange Swivel Joints

WOODFIELD

Safe Hands



Style – 40



Style – 30 w/ Handle

part of the **WOODFIELD**  
**APILOAD** product range

Designed and manufactured by Woodfield Systems

## Models & Specs

Woodfield **WL2PA swivel Joints** are designed specifically for the petroleum and fuel loading industry. Cast aluminum construction for light weight, with dual ball races for strong and smooth operation. The split flange design has been developed with maintenance and a long service life as a top priority. The H-Block O-ring main seal is field replaceable. To access the seal simply unbolt the split flange.

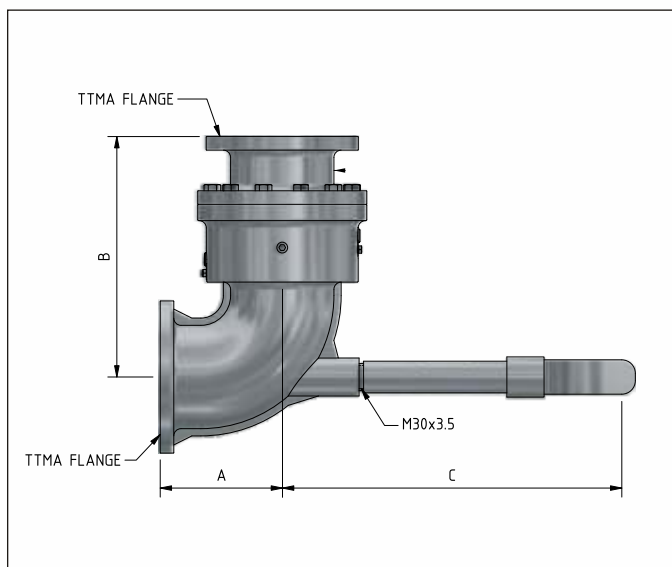

**Style - 30 w / Handle**

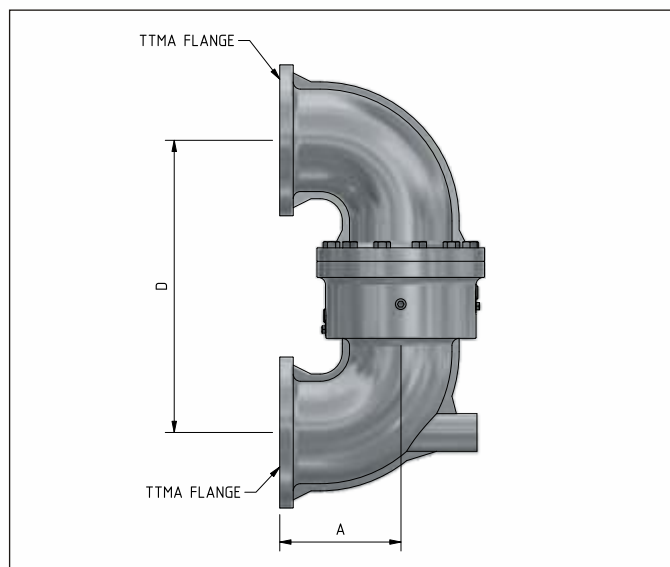

**Style - 40**

## Sizes & Configurations

SWIVEL SIZE	A (inch)	B (inch)	C (inch)	D (inch)	E (inch)	F (inch)	Weight Without Handle (lbs)				Handle Weight (lbs)
							S-30	S-40	S-50	S-70	
3 in.	4.33	10.08	14.17	11.46	12.05	13.39	14.11	13.23	22.05	23.15	1.32
4 in.	5.32	10.47	14.76	12.84	13.54	15.39	17.64	17.64	28.66	30.87	1.32

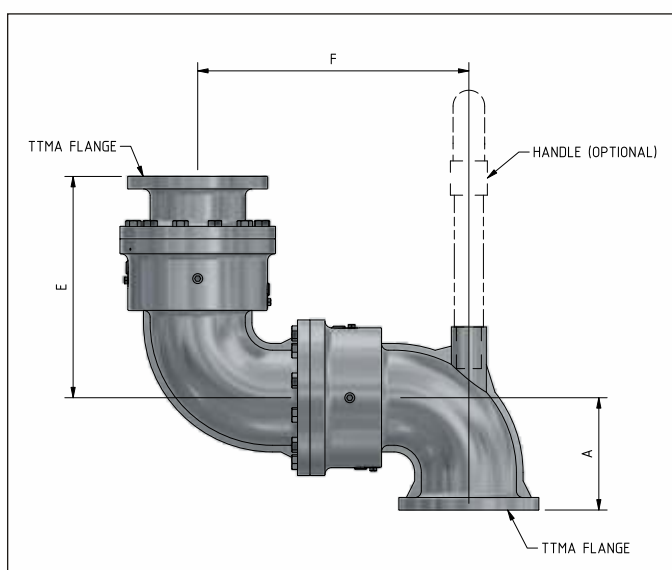

**Style - 50**

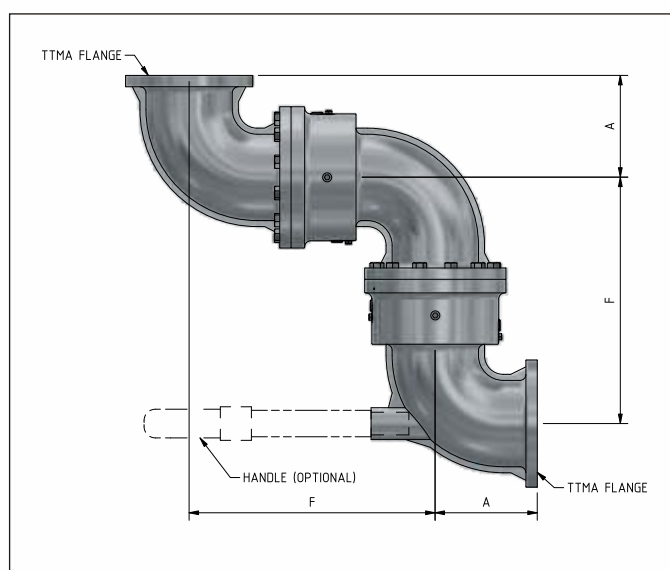

**Style - 70**

Standard seal options are Viton GFLT, Viton B and Nitrile, (consult Woodfield for more seal options). Styles - 30, 40, 50, and 70 WL2PA swivels are standard with Woodfield API Load Loading Arms. These can also be retrofit to most existing terminal loading arms.

The WL2PA utilizes Woodfield's **Uni-Seal** technology by featuring the same seals as all the other swivel joints in a Woodfield loading arm, making arm servicing smarter as well as simpler. Contact Woodfield today to learn more.

## Features

- Universal seal for all swivel joints of the same size
- Split flange design for simple & quick seal maintenance
- 3 year no touch warranty
- Cast TTMA flanged connections
- Dual ball race for strong longevity
- Ergonomic replaceable handles

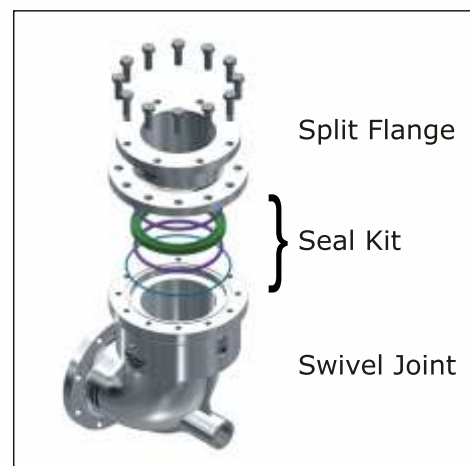

## Technical Details

Type / Model	WL2PA 3" & 4" Style-30, 40, 50 & 70
Sizes available	3in and 4in
Material of construction	Aluminum (Cast) – A356 T6
Seals	Viton GFLT, Viton-B, Nitrile/Buna, (other materials on request)
Test Pressure	15 bar
Working Pressure (Max.)	10 bar
Operating Temperature	Viton GFLT: -40°C (-40°F) to 100°C (212°F) Viton-B : -15°C (5°F) to 90°C (194°F) Nitrile / Buna: -30°C (-22°F) to 100°C (212°F)
End connection	TTMA flange
Applications	Petroleum, Hydrocarbons



## Woodfield APILOAD Product Range

The Woodfield APILOAD product range consists of a complete array of Woodfield bottom loading arm products. All manufactured by Woodfield to the highest standard and designed to compliment each other during their operation and to simplify service and maintenance when it is required.

### Bottom Loading Arms

- Single spot or up to 7 arm cross over within the API envelope
- Compression Spring balanced or Gas Strut



### Couplers

- WV400 API Coupler, 4 lug, snap-on, stainless steel sleeve, standard Viton GFLT seals



### Swivel Joints

- WSS single race or WL2+ Dual race heavy duty swivel joints
- WL2PA Aluminum split flange apex and outboard swivel joints
- TIMA Flanged



### Emergency breakaway coupling

- WBAC 4" API Breakaway Device, Aluminum, TTMA

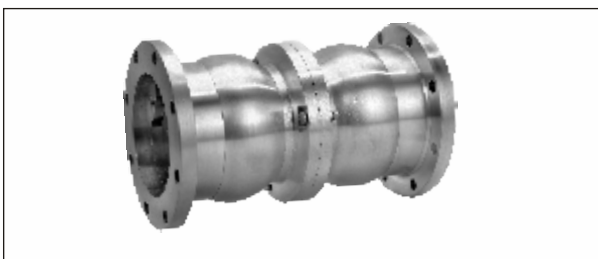

### Hoses

- HD Drop Hoses, SS braided or composite construction

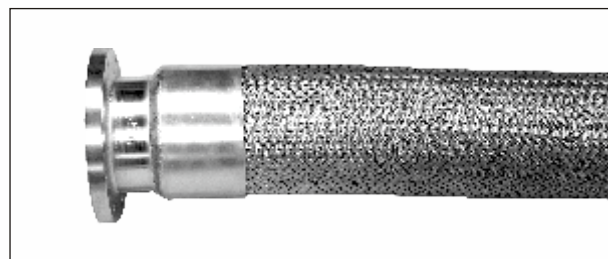

#### Woodfield Systems USA Inc

200 Business Park Boulevard, Columbia,  
South Carolina 29203. USA.  
US/Canada Toll Free :+1 888 915 6266  
International :+1 803 399 7597  
Email: sales.usa@woodfieldsystems.com

#### Woodfield Systems International

302 -A, Nitco Biz Park, Wagle Estate,  
Thane (W) - 400604.  
Maharashtra, India.  
Phone: +91-22-6704 0000  
Fax: +91-22-6704 0099  
Email: sales@woodfieldsystems.com

#### Woodfield Systems Europe SL

Avda, San Francisco Javier, 9  
Off. 1129, 41018  
Sevilla, Spain  
Phone: +34 955 300 424  
Email: sales.es@woodfieldsystems.com