

**RAIL AND TRUCK
LOADING & UNLOADING SOLUTIONS**

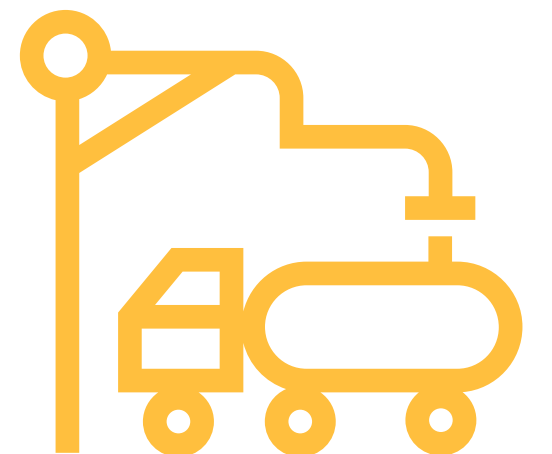



RAIL AND TRUCK LOADING & UNLOADING SOLUTIONS

Our carefully engineered products ensure safe transfer of volatile and hazardous materials like petroleum, compressed gas, cryogenic liquids and chemicals. Our range includes loading arms for top or bottom loading and unloading applications.

STANDARD FEATURES

APPLICATION RANGE

From food-grade liquids to highly toxic chemicals, from liquid gases to hot bitumen, a wide variety of applications are possible.

MATERIAL OF CONSTRUCT

Standard Materials

Aluminum,
Carbon Steel, Stainless Steel

Speciality Materials

alloys like Monel, Inconel, Hasteloy, Duplex & Super Duplex

SWIVEL JOINT

Woodfield Swivel Joints are designed, manufactured, quality checked and tested for ease and safe operation.

Seal Material

Nitrile, Viton, PTFE and others as compatible

STANDARD SIZES

2" to 6"
Others on request

STANDARD BALANCE

Spring Cylinders
Gas Struds
Counter Balanced
Pneumatic or Hydraulic operation is available on request.

DESIGN TEMPERATURE

-196°C to +300°C

DESIGN PRESSURE

Upto 40 bar

View our full range of models at woodfieldsystems.com

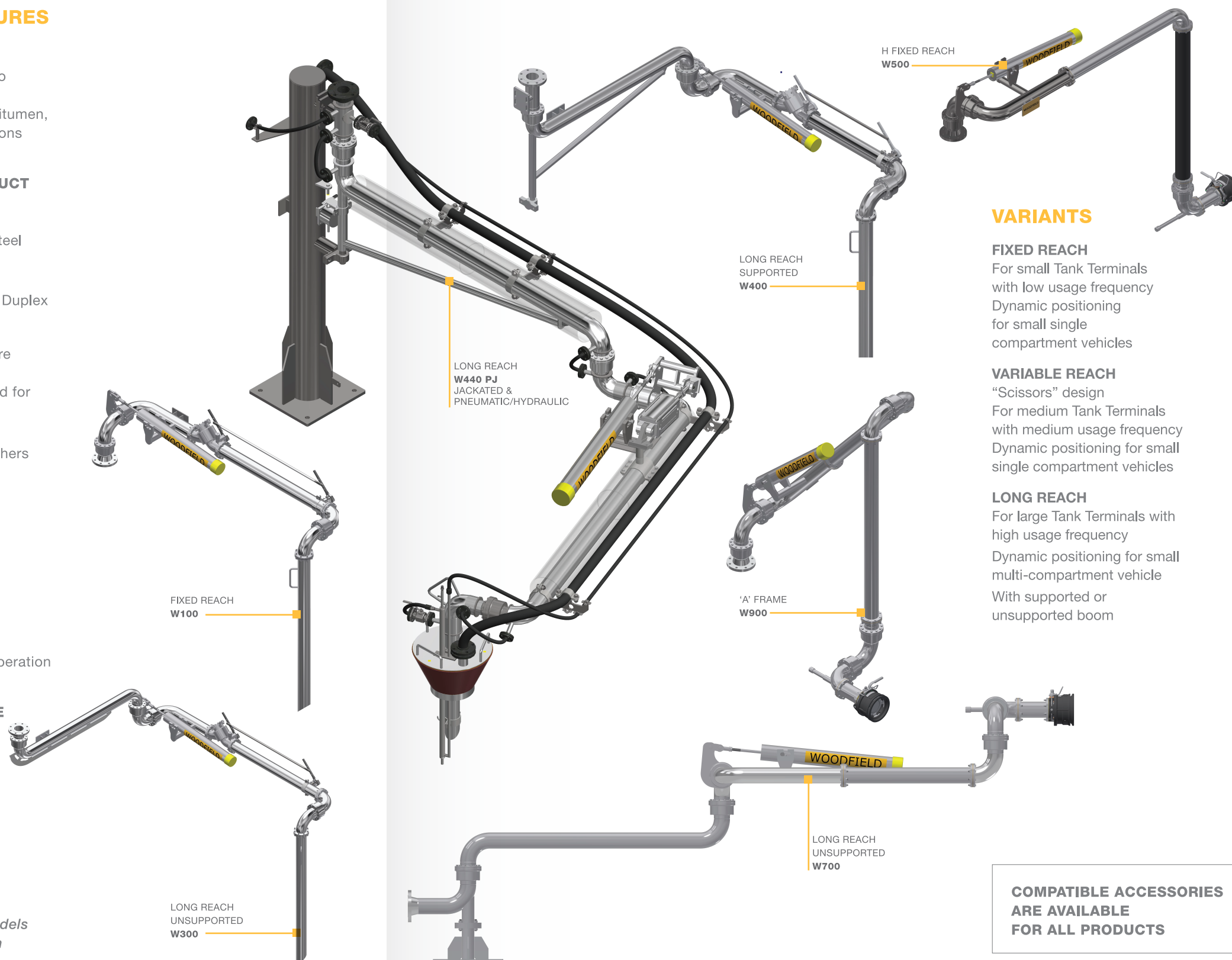

CRYOGENIC LOADING ARM

The Woodfield Cryogenic Loading Arm is a critical solution for the safe and efficient transfer of cryogenic liquids in industries such as LNG, chemicals, and pharmaceuticals. Designed for handling extremely low-temperature substances like LNG, liquid nitrogen, this state-of-the-art equipment ensures secure, leak-free connections and minimizes the risk of contamination.

FEATURES

- Safety & Compliance: Meets global safety standards and regulations.
- Durability & Efficiency: Manufactured with corrosion-resistant materials for long-lasting, trouble-free service, even in extreme environments.
- Flexibility: Adaptable to various transfer scenarios, for various tank nozzle heights with cross over possibilities.
- Ease of Operation: Ergonomically designed with HD spring balancing unit for simple, one-person operation, reducing the need of multiple personnel and minimising risks.
- Precision: Delivers accurate and controlled performance, ensuring safety of product & environment.
- Durable Construction: Made from stainless steel, providing exceptional strength and reliability in diverse environments.
- Versatile Sizing: Cryogenic Loading and Unloading Arms are available in 2", 3" and 4" sizes.
- Pressure Specifications: Standard design pressure up to 20 bar. Higher pressures available upon request.
- Wide Temperature Range: Designed to operate effectively between -196°C and +100°C.
- Enhanced Sealing: Equipped with specially designed, self-energized cryogenic seals.
- Bottom Loading Configuration: Can be configured as a Bottom Loading Station, featuring two arms (one for liquid and one for vapor) mounted on a single stand-post for efficient operations.
- Smooth Swivel Operation: Features a swivel joint with nitrogen gas purging to maintain smooth operation even in icy conditions.



Woodfield Shield, our comprehensive after-sales support programme, is designed to efficiently maintain all active equipment produced by Woodfield Systems.

Post-handover, a customer can avail of priority technical support from a highly responsive team of experts. The Woodfield Shield team provides on-site and online support and is committed to quick turnaround time.

We manufacture all the spare parts needed for any Woodfield equipment.

